



EX. 1031 1/3  
0902-020



CITY OF MERCER ISLAND



MyBuildingPermit.com

### Plumbing Permit

MyBuildingPermit.com

Permit Information			
Permit Number	E09-00735	Issued Date	2/5/2009
Job Address	7709 W MERCER WAY	Expiration Date	8/4/2009
	MERCER ISLAND, 98040	Fees Paid	\$69.00
Floor		Order Confirmation	30167
Suite		Related Permit #	

People Information			
Property Owner	SHANE M MILLER	Contractor	
Address	7709 W MERCER WAY MERCER ISLAND,	License #	NA
Contact Name	SHANE M MILLER	Phone #	000-000-0000
Phone #	2069108443	Tenant Name	SHANE M MILLER

Job Description
A (Single Family) (Alteration) project installing (1 Water Supply Piping 1.25) <i>Final - As-built with BPC 2-26-2009</i> <i>Key to Backflow 02-17-09 B/M</i>

Permit Comments - permit must be posted on site
1. Do not cover any work until an inspection has been approved. 2. New or replaced water service piping materials must consider the buildings electrical grounding system. At a minimum, 10 feet of metallic piping must be in contact with earth when the piping is part of the electrical ground system (or a licensed electrician shall install approved electrical ground rods). 3. Hot Water Heaters - please see Tip Sheet #7 - Water Heaters for Installation tips. 4. New Drain, Waste and Vent systems must be tested with a minimum of 5 psi of air or by filling the system with water to provide not less than a 10-foot head on all piping. Test must be applied for 15 minutes and witnessed by inspector. 5. New or replaced water supply lines must be tested and proved tight under a water pressure not less than the working pressure under which it is to be used. A 50-psi air pressure may be substituted for the water test. Test must be applied for 15 minutes and witnessed by inspector. 6. A completed certified Backflow Prevention Assembly Test Report is required prior to inspection, copy of report and other pertaining information can be obtained at <a href="http://www.mybuildingpermit.com/ip/bflowrpt.asp">http://www.mybuildingpermit.com/ip/bflowrpt.asp</a> .

Certification Statement	- The applicant for this permit states that:
I certify that I am the owner of this property or the owner's authorized agent, including an appropriately licensed contractor. I have furnished true and correct information. I will comply with all provisions of law and ordinances governing this type of construction work, whether specified herein or not. I understand that failure to comply with the above may result in revocation of the permit resulting from this application.	

Call For Inspections				(206) 236-3587			
Inspection	Ivr	Inspector	Date	Inspection	Ivr	Inspector	Date
Water Service				Final			
Groundwork							
Rough In/Test							
BackFlow							



**CITY OF MERCER ISLAND**  
 9611 SE 36th Street, Mercer Island, Washington 98040-3732  
 PHONE (206) 275-7605  
 www.mercergov.org

EX. 1031 2/3

## Water As-Built / Field Survey

Type of As-Built (check one):  New Water Service  Service Line Repair  Main Line Repair

Homeowner's Name: Miller, Shaane Miller Date: 02-26-2009 Work Order: \_\_\_\_\_

Address: \_\_\_\_\_ Map Page: \_\_\_\_\_ Permit: 0902-020

Contractor's Name: OWNER

~~Pavement~~ Type: \_\_\_\_\_ Area Cut: \_\_\_\_\_

~~Main~~ Size: \_\_\_\_\_ Type: AC: \_\_\_\_\_ DI: \_\_\_\_\_ CI: \_\_\_\_\_ PVC: \_\_\_\_\_ STL: \_\_\_\_\_

Depth of Line: \_\_\_\_\_ Service Line Size: \_\_\_\_\_ Service Line Material: \_\_\_\_\_

Main Line Location: \_\_\_\_\_

Main Line Condition: \_\_\_\_\_

Supply Line Size: 1.25 Supply Line Material: 200 PSI Poly

Meter Location: \_\_\_\_\_

Old Meter Number: \_\_\_\_\_ Size: \_\_\_\_\_ Make: \_\_\_\_\_

New Meter Number: \_\_\_\_\_ Size: \_\_\_\_\_ Make: \_\_\_\_\_

MXU: \_\_\_\_\_ REG: \_\_\_\_\_

Comment: Supply Line Only Repair - Partial

(Turn Page Over for Map)

Please Return Form to GIS: Leah Llamas.

Definitions: Service Line = Main to Meter

Supply Line = Meter to House

EX. 1031 3/3

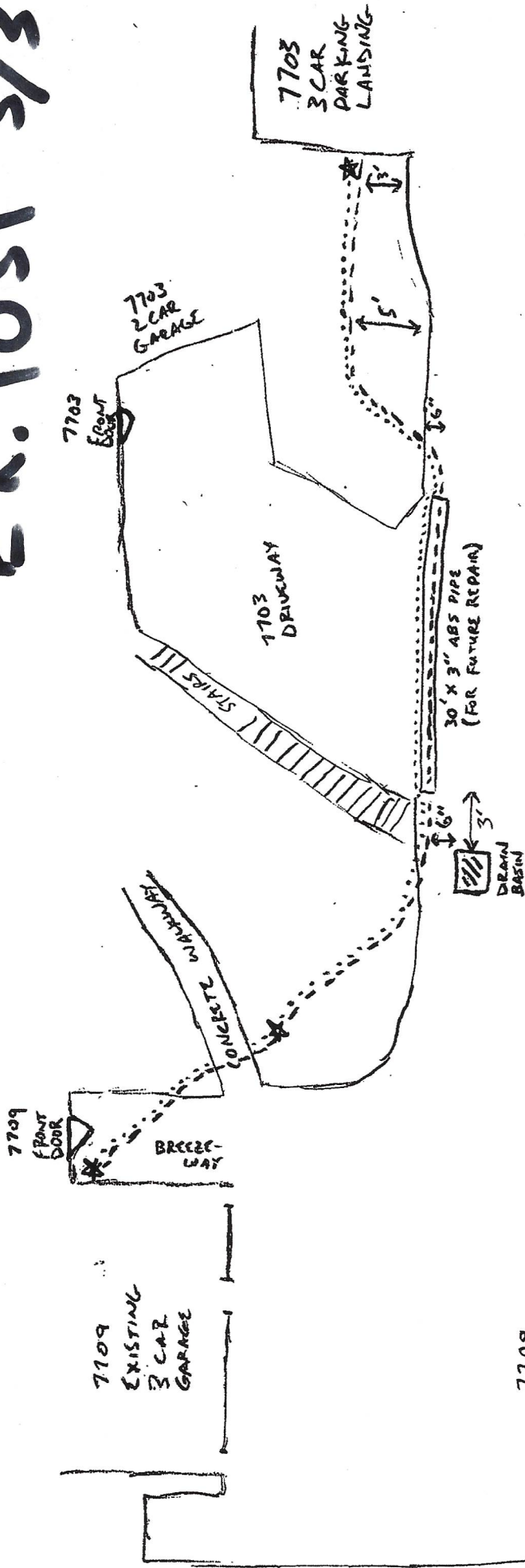

AS BUILT SKETCH  
 7709 WEST MERCER WAY  
 WATERLINE REPLACEMENT  
 (120')  
 2/22/09 OWNER: MILL



EXISTING ROCKERY RETAINING WALL

LEGEND	
---	200PSI POLY WATERLINE
....	14 GAUGE WIRE (FOR LOCATES)
★	CONNECTION COUPLING POINT

SHARED DRIVEWAY AREA

7709 DRIVEWAY